

# MEMOIRS

## 1971



Jackson, P. 1971 "Two Small Mine Buildings of Alston Moor"  
Memoirs NCMRS, Vol.2 No.1, pp.29-30.

Published by the

THE NORTHERN CAVERN & MINE RESEARCH SOCIETY  
SKIPTON U.K.

© N.C.M.R.S. & The Author(s) 1971.

**NB**

**This publication was originally issued in the 10 by 8 inch format then used by the society. It has now been digitised and reformatted at A5. This has changed the original pagination of articles, which is given in square brackets.**

## TWO SMALL MINE BUILDINGS OF ALSTON MOOR

Peter Jackson

Associated with mining regions are numerous small buildings of various functions which were all important in the satisfactory operating of a mine complex. Alston Moor, in Cumberland, has scattered examples of several types of mine buildings, some of which in the Upper Nent Valley have already been described (Jackson, 1969).

The two buildings described in this article have no relationship to each other, but were surveyed during the course of other work during 1969.

[29]

### Haggs Candle House

NGR: NY 7665.4595

Standing close to the Alston-Nenthead main road is the former candle house of Nentsberry Haggs Horse Level. The building is of locally quarried sandstone, of a type which splits very well, and the roof is covered with stone slates of a similar sandstone. The roof structure consists of timbers  $2\frac{1}{4}$  inches by  $\frac{1}{2}$  inch deep parallel to the ridge every 9 inches, supported by timbers 3 inches by  $3\frac{1}{2}$  inches deep parallel to the side walls every 12 inches. This framework is supported by one 4 inches by 9 inches deep timber midway beside walls and ridge pole, which is 4 inches square. The stone slates are secured by wood pegs, with seven rows of slates being needed on each side. Inside the building, the walls are plastered and there has been a horizontal plaster-lath ceiling. No sign remains of any shelves which probably have once existed in the building. The stone fireplace with the remains of an iron fire grate, rests upon a stone slab floor.

The present state of the building is poor, with the north-west wall being partially collapsed, but the roof is complete except for one or two slates.

No date is known by the author for the date of construction, and it is assumed that the building fell into disuse about 1910-12 when acetylene lamps were introduced to the Nenthead mines, according to local information.

The building is at present disused.

### Greengill Shop

NGR: NY 7645.4335

This building lies on the north-west side of Green Gill Hush, an old excavation on Green Gill Vein. It is the only building at this site which can be reasonably reconstructed, all the others having been reduced to their foundations. The walls which remain consist of locally quarried sandstone, and the floor is of similar stone slabs. There are no remains of the roof at all.

An unusual feature of the building is the low height of the side walls which are only 5 feet high from the floor. No dates of usage of the building are known by the author.

Reference

Jackson, P. 1969 The Mine Buildings of the Upper Nent Valley, Part One, Buildings Extant. N.C.M.R.S. Memoirs 1969.

[30]

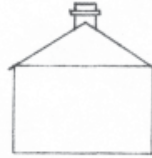
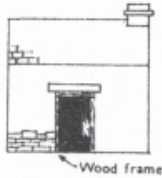
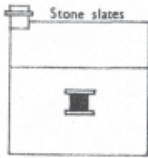

HAGGS CANDLE HOUSE

SCALE One Inch equal to ten feet  
PJ 5/69.

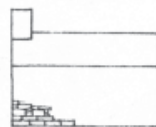
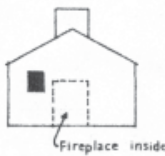
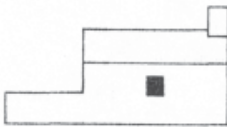
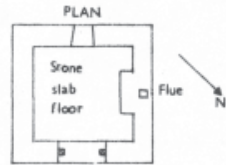

GREENGILL SHOP

SCALE One Inch equal to ten feet  
PJ 5/69.

